

---

## QUICK INSTALLATION GUIDE

---

WIRELESS M-BUS TO MODBUS (LAN-WMBUS-MOD-TP)



## IMPORTANT!

Appropriate disconnection device, such as a power supply cable with socket, shall be used as part of the building instruction. It should be close to the device and easily accessible to the user. Furthermore, a 230 VAC installation MUST be carried out by authorized installer according to the relevant electrical safety regulations.

### Installation location and direction:

It is recommended to install the device to the wall, but they can also be installed to the ceiling. It is highly recommended to mount the device as the image below.

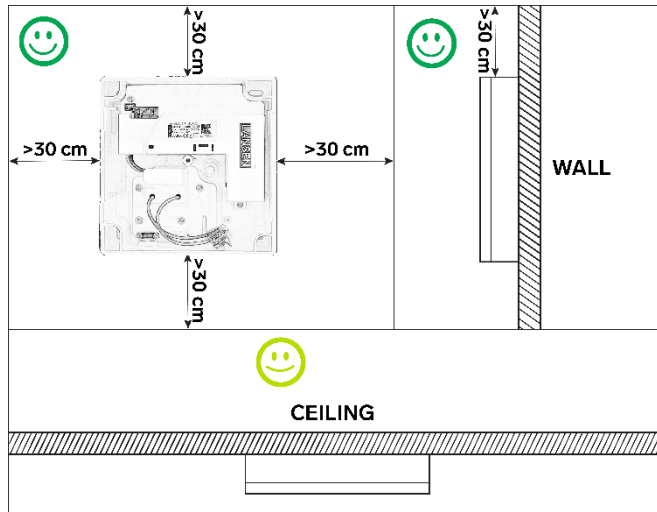

1. Find a suitable place to install the device.

2. Unscrew the screw (marked with a red circle on the image below) and remove the cover by pushing the clips at both sides of the cover.

**NOTE:** The screw is a Security Torx T20H (with a small pin in the middle).

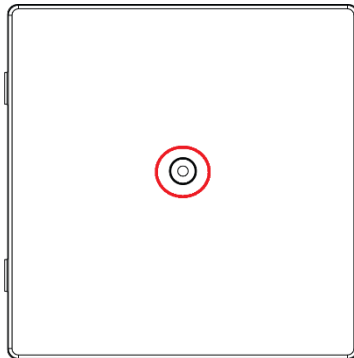

- The power supply cables can be mounted either through the cable guide on the side or through the hole on the back. By using the hole on the back, the device can be mounted directly on an outlet to hide cables.
  - If the hole at the back is going to be used, go to step 4.
  - If the cable guide on the side is going to be used, go to step 5.
- To use the hole at the back for power supply cable, carefully cut, drill, or punch out the hole marked in the picture below.

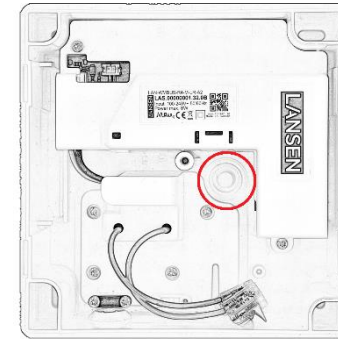

- Take the device and hold it where it is going to be mounted. Mark the holes, pre-drill if necessary (depending on the material), and mount the device by using four screws (not included).

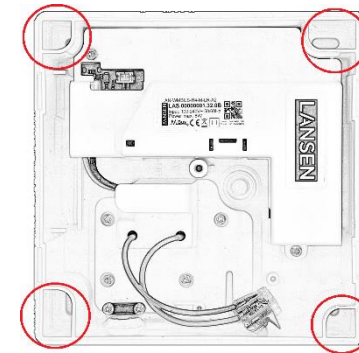

6. Strip the power supply cable according to the diagram below.

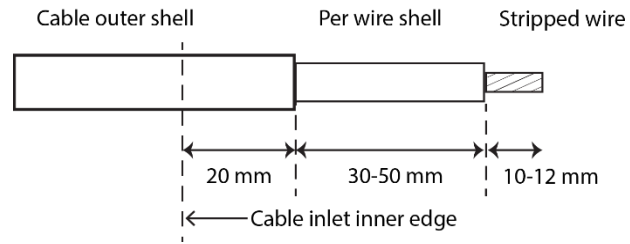

7. Thread the power supply cable through the preferred cable inlet, either from the back prepared in step 4 or through the cable guide on the side, as marked by red circles below.

**NOTE:** If the cable guide on the side is used, make sure to use the strain relief (included in the package).

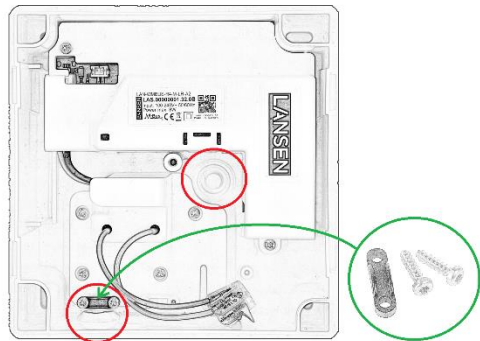

8. Prepare the MODBUS cable and thread the cable through the cable inlet as marked by the red circle below.

**NOTE:** Make sure to use the strain relief (included in the package).

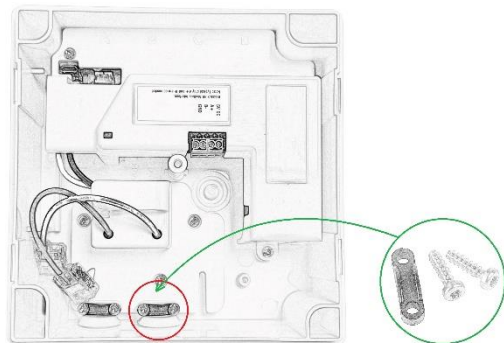

9. Install the MODBUS cable to the screw terminal by following the markings on the label. **NOTE:** Typically only A+ and B- are connected.

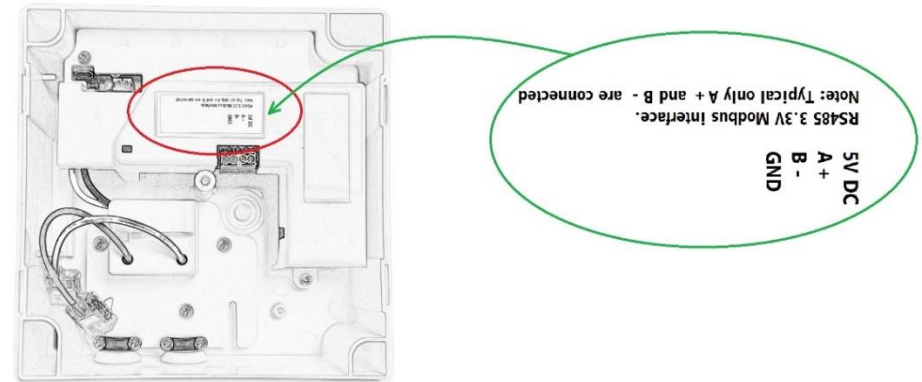

10. Connect power to the device. Three beeps will be heard during startup.

**NOTE:** If more beeps are heard a few seconds (~5s) after the first beeps, there is a problem with the device - Contact place of purchase.

11. Attach the cover and mount the screw (marked with a red circle on the image below). Make sure the clips at both sides of the cover are firmly attached.

**NOTE:** The screw is a Security Torx T20H (with a small pin in the middle).

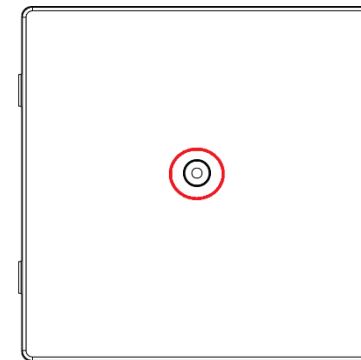

12. Configure the device either by using our program Lansen Configurator together with a Lansen USB-dongle or by sending wireless configuration packets from any transmitter. Contact Lansen for more information.