



---

## QUICK INSTALLATION GUIDE

---

OCCUPANCY DETECTOR (LAN-WMBUS-OD-PIR)

OCCUPANCY DETECTOR/TEMPERATURE/HUMIDITY/SOUND/BRIGHTNESS (LAN-WMBUS-OD-EQ)



### Recommended mounting instructions:

- For maximum range, mount the device and receiver so they have the same polarization.
- Avoid placing directly against metallic objects to maximize range.
- Avoid, if possible, mounting facing windows.
- Avoid mounting device facing heating elements such as radiators or heat pump.
- Avoid mounting near strong electromagnetic generating devices, such as motors.
- Mount with screws.

### **Step 1: Find a good installation placement**

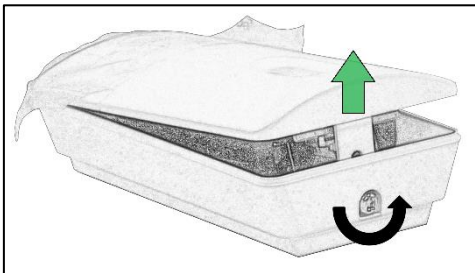
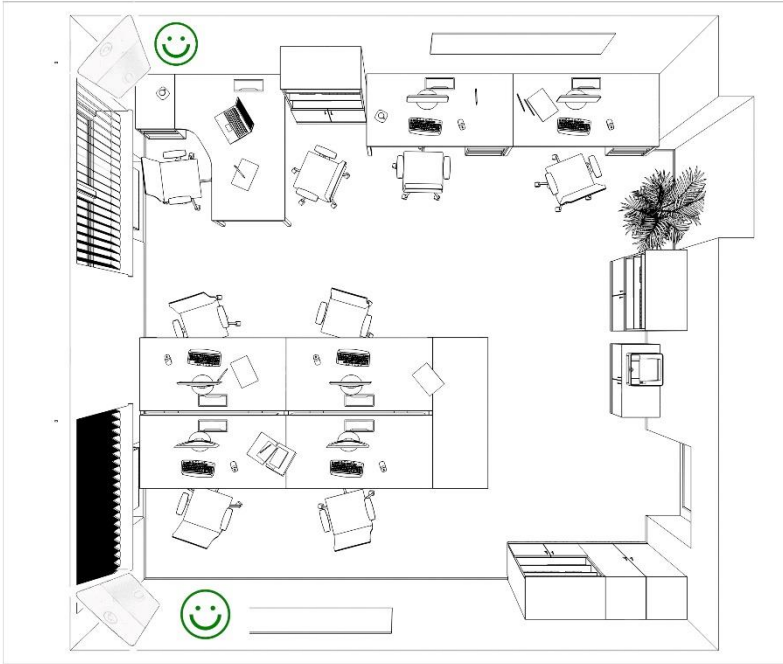

### Step 2:

Unscrew the screw at the bottom of the device by turning it counterclockwise. Separate the front and back piece by lifting the front piece as shown.

If corner bracket is going to be used, go to **Step 3**. Otherwise go to **Step 5**.

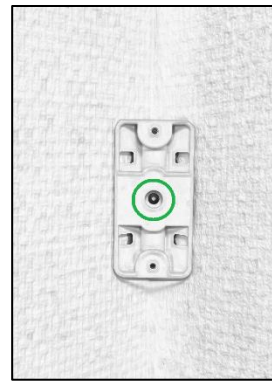

### Step 3 (optional step if corner bracket is used)

Install the corner bracket, preferably in a corner but it can be used on any wall, using the recommended mounting instructions on top of this document and placement guidance from **Step 1**.

Install the corner bracket using a screw (not included) in the marked hole in the middle of the bracket.

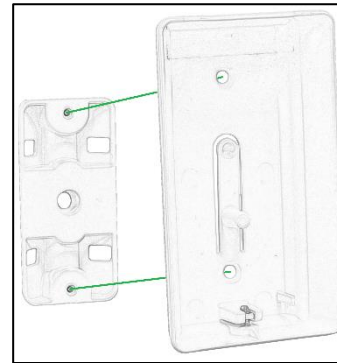

### Step 4 (mount back piece to corner bracket):

If corner bracket is used, then mount the back piece of the PIR on the corner bracket using the included two screws as shown in the picture.

Go to **Step 6** (skip **Step 5**).

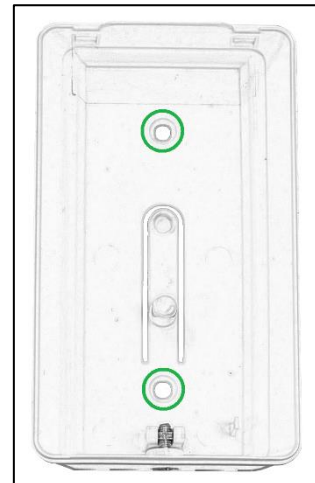

### Step 5 (mount back piece on wall):

If **NOT** using corner bracket then the device should be mounted on a wall. In this case, mount the back piece to a wall using two screws (not included) in the marked holes.

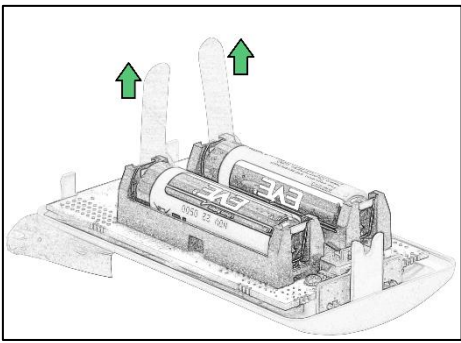

**Step 6 (activate device):**

Remove the plastic pieces at the two batteries to start the device.

A red LED will start blinking on the front when the right battery is inserted.

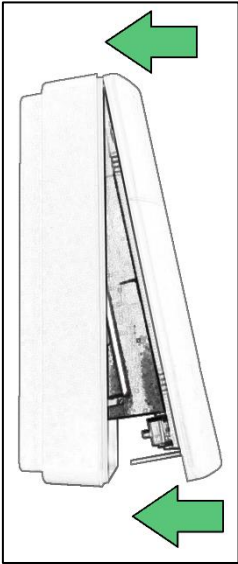

**Step 7 (mount front piece):**

Mount the upper part of the front piece to the back piece and then attach the bottom part of the front piece to the back piece.

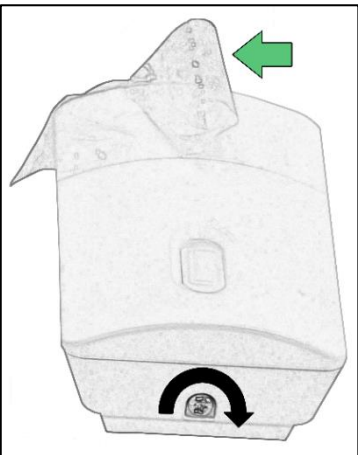

**Step 8:**

Attach the screw that was removed in **Step 2** at the bottom of the device. Tighten the screw by turning it clockwise.

Peel off the plastic film at the top of the device.

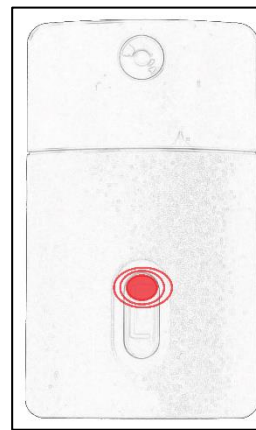

**Step 9 (test device):**

Test the device by either walking past it or by moving, for example, a hand from right to left or left to right.

A red LED on the front will light up to indicate that the device detected movement.

**Note:** The red LED will only light up due to movements for the first 10 minutes after inserting batteries. This is to verify during installation that the device is working properly.

Make sure that the device is securely mounted.

Installation is complete!